

Student Recreation Center Expansion Project
 User Group Meeting 2
 April 1, 2011
 8:30 am - 10:00 am

Meeting Notes

<u>User Group in Attendance:</u> Mike Eyster, Student Affairs Julie Haack, Chemistry Geoff Hale, Student/SRC Advisory Board Brent Harrison, SRC Bryan Haunert, SRC Kristen Gleason, EMU/Club Sports Dennis Munroe, SRC Jen Phillips, Neuroscience Derick Olsen, Student/SRC Rob Thallon, AAA Sue Wieseke, SRC Michelle Vander Heyden, Student/ASUO	<u>Other Participants:</u> Kody Nathe, Architecture Student/SAFAC Member
	<u>Staff in Attendance:</u> Gene Mowery, CPRE Emily Eng, CPRE
	<u>Notes by: EE/GM</u>

1. Introductions
2. Favorite Campus Spaces Discussion
 - (A) Brent: Footbridge over Willamette River (Frohnmayr foot/bike bridge, formerly known as Autzen foot/bike bridge)
 - 1) Open to All UO students and community
 - 2) Spectacular Views
 - 3) Wide Open Space
 - 4) Inviting, Welcoming
 - 5) Encompasses & encourages activity- Walking, Running, Biking
 - 6) A Social Space
 - 7) People want to go there
 - 8) Access from both directions
 - 9) Open all year round
 - 10) At times busy, but also at times very quiet and serene
 - (B) Bryan: Alumni Center Lobby (project still under construction)
 - 1) Inviting “grand” staircase in atrium space.

- 2) Open: Can see everything that is going on while in the atrium space which contributes to space organizational clarity, ease of wayfinding, building transparency – can see across and through the different spaces.
 - 3) Lots of natural light
 - 4) Seeing all that you have to offer as you walk in (Dennis)
- (C) Kristen: Knight Law School Lobby/atrium space and stair; Law School east courtyard; Living Learning Center north building – south side patio. Likes openness and quality of light of atrium space; likes quality outdoor open spaces
- (D) Gene: Informal study space in Knight Law school - 2nd level, between atrium and east outdoor courtyard. It is a niche space with great daylight and opportunity to dwell in the parameter/edge of both the larger indoor and outdoor spaces – feel sheltered in own space and able to observe the larger spaces.
- (E) Jen: Outside Vivian Olum Child Center – view across parking lot.
- 1) Mental space to visit ... transition from primary role of motherhood to UO faculty
 - 2) Headspace from one life mode to another
 - 3) Think about inclusion of other people (part of community) you never see (i.e. children); how do you make the SRC a more family/transition/inclusive friendly space?
 - 4) How to make smooth transition?
- (F) Julie: Back weight/cardio room of SRC (versus 1999 constructed weight room in NE corner)
- 1) As faculty, you don't have a lot of time
 - 2) Space is more efficient (which is primary point) and easy to use – better layout.
 - 3) Can see people easily, service desk is not in the way (as it is in the 1999 room)
 - 4) Doesn't care about natural light.
- (G) Michelle: LLC Patio – south side of North building
- 1) Nice transition indoor and outdoor space
 - 2) Transition from living quarters/dining area to greater campus
 - 3) Lots of energy, especially on sunny days
 - 4) Sound of the rain on the roof is nice
- (H) Mike: Spaces that promote interaction
- 1) Many Nations Longhouse
 - 2) EMU – Mike noted that space doesn't work well but students will find a place for interaction anyway, but it's so much nicer if its intentional
- (I) Geoff: EMU Fishbowl
- 1) When I think of campus, I think of this ... if something is going on it is right there
 - 2) Really good energy with a lot going on
 - 3) This is Eugene
 - 4) People watching place – just sit down and watch.
- (J) Derrick: Sun Deck at Gerlinger
- 1) Great light, warmth
 - 2) Not too busy
 - 3) Architecture is amazing
- (K) Kody: Cascade Fountain
- 1) A lot of different tiers, a lot of spaces you can inhabit. Multitude of spaces.

- 2) Connects 2 buildings with bench a building/fountain overlook
- 3) Really nice when fountain is running
- 4) Applicable to SRC transition area - space on periphery in association with café space: stepped café, deck concept.
 - a. Also noted inclusion of protected overhead area to wait or hang out, similar to LLC south side covered area, could be part of this space.

(L) Sue: Lillis Atrium and casual area in Jaqua

- 1) Lillis- Open, light, lots of glass, activity along perimeter
- 2) Jaqua- like fireplace, areas for gathering
- 3) Dennis noted: Education Building Hearth also does this well

3. Pattern Themes Discussion

(A) “Building as Tool for Teaching and Engaging Users in Sustainability”

- 1) Dennis likes the visible sustainability features in Lillis, such as the PV arrays visible in the atrium glass
- 2) Want to “daylight sustainability” in SRC – make it visible. Goal would be to make the SRC a “Living Learning Lab”; play in a space where you see or experience sustainability.
- 3) Energy Kiosk noted. Current one somewhat tucked away. Needs to be more front and center for user engagement. Gene noted that the new Alumni Center will have a good example of energy screen that should engage users up and running in mid-May.
- 4) Signage to describe sustainable/“green” features noted as one avenue for educating building users, particularly for features that are not seen, which is the case for much of sustainable/energy efficient design. OSU uses this method.
- 5) Generate power through exercise equipment used as an example of sustainability / energy usage that is on the surface, easily understand, and engaging to users.
- 6) The more “on surface”, the more engaged and appreciated by users
- 7) Julie suggests reaching out to partners and noted that OMSI is a leader in creating spaces for learning at multiple levels of understanding (kids through adults). Consider using them as consultants?
- 8) Opportunity to educate about the science behind SRC technology, equipment, processes
- 9) Human Physiology - potential partnership in educational aspect of SRC.
- 10) Need to think about the challenges of keeping the technology operational: who is maintaining and managing educational tools, so that they are always reliable and function (example given of current kiosk often breaking down
- 11) Suggested that we consider dynamic display space for showcasing campus projects from such sources as physiology and green chemistry. Operate on temporary/rotating basis.
- 12) SRC has some unique opportunities for technology, energy efficiency such as preheat water for pool using solar and using “human gerbils” for generating power on exercise equipment.
- 13) A high level of importance given to sustainability and energy efficiency has been a constant these amongst students for years. Students in the user group concur.

- 14) User group supports “pushing the envelope for sustainable, integrative, energy efficient design within the constraints of the budget ... be mindful of the reality of balancing with the program elements.
- 15) It is thought that “pushing envelope” will draw more students; UO is forefront for sustainability; UO takes pride in sustainability
- 16) Michelle noted that it is neat knowing that you are contributing to energy generation ... human gerbil idea. Educational signage will contribute to knowing how you are contributing.
- 17) Tie to health and environmental impact to the place where you go to be healthy is of importance.
- 18) Opportunity to reach out to other organizations to fund pieces that budget can't afford.
- 19) Potentially go after grants for sustainable features and educational aspects of SRC.
- 20) Important to tell the story of what we're doing
- 21) Opportunity to use sustainability as a fundraising tool – donations specific to enhancing/pushing sustainability goals. Dennis noted that there is a new position created for a Student Affairs Development Officer and the position should be filled in a couple of weeks.

(B) Tech Savvy

Note: Some of “Tech Savvy” discussion woven in with sustainability discussion.

- 1) Technology of cardio machines changes quickly and is really stepping up. Need to be cognizant of energy impacts in cardio equipment, for example the energy used for interactive screens on a machine. Need to weigh equipment features with their energy use/greenness ... what kind of technology do we want to push on cardio equipment.
 - 2) Create functional space that allows flexibility for technology change.
 - 3) There is passive technology too (i.e. water systems – rainwater; reduce potable water use)
 - 4) Wireless: no dead zones as the SRC currently has.
 - 5) Considerations for close-circuit TV monitoring (U. of Arizona cited as example)?
 - 6) Breadth of “savvy” technology takes in a lot of items not necessarily noticed such as lighting systems and controls, HVAC equipment types and controls, security systems, membership service system, etc...
4. Recreation Center Image Tour (Note: we did not complete the image tour due to time constraints. Images below depict those slides that we did look at)

(A) Natatorium / Aquatics Facility Discussion

General comments related to Natatorium slides:

- Be careful of amount of light; Glare can affect lifeguards (Kristen)
- Propose review of historic photo of Sutro Baths (Rob). Gene noted that ideally we would have photos of historically significant examples, but this tour was limited to contemporary recent sources.

- Opinion on sightlines into pools? Most of group thinks it is acceptable (one against and three neutral)

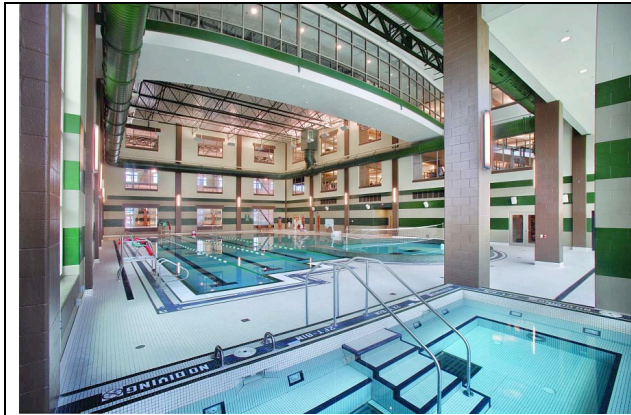

- Likes the windows /transparency between the pool area and other areas of the rec center (Bryan)
- Doesn't like windows looking in to pool area (Julie)
- General consensus is windows/transparency between pool and other areas of the rec center is acceptable.
- Pillars affect sightlines (Brent)
- Too busy, like soft features
- Too many hard surfaces looks clinical (Dennis)



- Industrial looking (Sue)
- Like functionality of pool; size is adaptable for large range of activities (Bryan and Jen)
- Need functionality not just for recreation, but also education (Brent)
- Facility should not just be for athletic swimming – should have recreation component (Dennis)
- Nothing special/very industrial (Michelle)

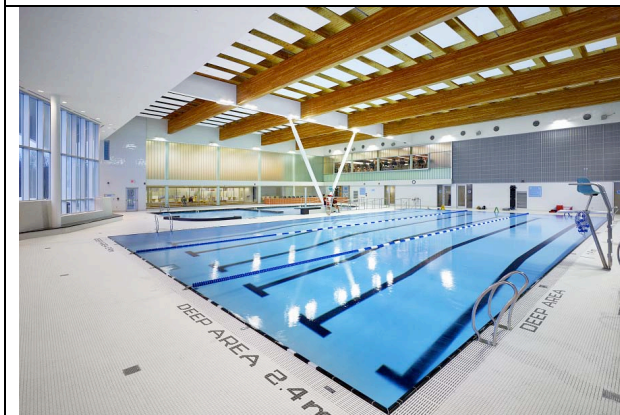

- Like wood beams (Brent; Bryan)
- Interesting way to put nature into space in a way that's modern but not too trendy (Julie)

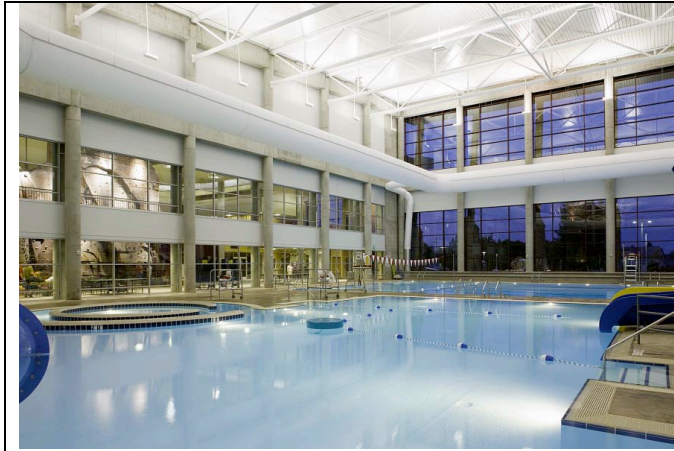

- Like seeing in and out of different spaces and to other parts of building (Bryan)
- Clarity in organization (Rob)



- Too fancy
- Too much like a spa



- As lifeguard, does not prefer – too dangerous and difficult to supervise/ monitor; Diving boards serve same function (Kody)
- As student, awesome (Kody)



- Not over the top; like lounge chairs and that it is colorful (Bryan)
- Hate (Rob)
- Hate (Sue)
- Change tile! (Dennis)
- Would be nice if pool area in SRC could open up to outdoors in summer (Kody)
- What are the accessibility challenges? (Brent)
- Above grade tubs seem less accessible; seem like objects/circulation seems not efficient (Rob)
- Either scenario would require some kind of lift assistance (Dennis)

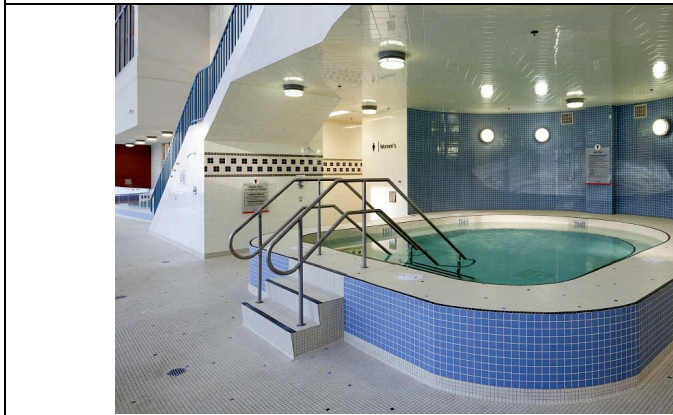

- Looks like a toilet (Jen)

(B) Food Service Discussion



- Can't have random interaction (Michelle)



- Looks like a fast food place (Michelle)



- Don't want to go there (Michelle)



- Seems like a space for interaction (Michelle)

(C) Social & Study Space Discussion



- Looks like an Airport (Dennis)
- Like lots of space prior to entry
- Like cardio looking down into space (Bryan)
- Good for working alone and stepping to side for interaction (Julie)

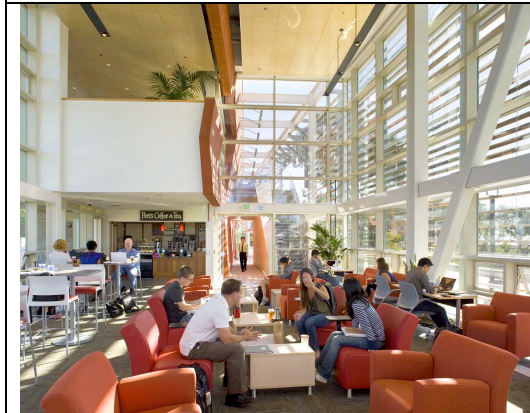

- Too dense (Rob) ... but like natural light and mixture of seating types and configuration



- Too nice
- Looks like hotel (Sue)
- Looks like hospital waiting room

- Looks good in picture (Bryan)
- Can't get anything done there because too many people passing by that you know (Michelle)



- Will use them if they are there, but wouldn't plan a space like this (informal space off to side) (Bryan)

- Tech savvy place; Need place for plugging in (Brent)
- Looks like restaurant (Dennis)
- Don't like restaurant aspect (Bryan)



- Like atmosphere of looking into activities (Bryan)
- Concerned about noise level; Basketball activity is very loud in UO SRC (Michelle)
- Would like to explore rental/income opportunities (want space that's able to be opened up or enclosed to rent out) (Brent)

5. Briefly reviewed RFQ Status

- (A) Advertisement out next week
- (B) Proposals due week of 4/17
- (C) Review and score proposals week of 4/24
- (D) Interviews week of 5/22

6. Next meeting we will review Project Description draft material and prepare for RFQ proposal reviews.

-End of Meeting-